

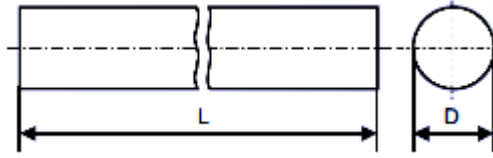

实心毛坯圆棒



D mm	L	EMT100	EMT210	EMT409	EMT412	EMT509	EMT512	EMT609	EMT612
1.25	330	○	●						
1.45	330	○	○						
1.60	330	○	○						
1.80	330	○	○						
2.00	330	○	○						
2.25	330	●	●						○
2.50	330	●	●						
2.75	330	●	●						
3.15	330	○	○						
3.30	330	●	●	○	●	○	●	●	●
3.50	330	○	○						
3.75	330	●	●						
4.25	330	●	●	○	●	○	●	●	●
4.75	330	●	●						
5.25	330	●	●	○		○	○	●	●
5.40	330	○	○						
5.80	330	○	○						
6.30	330	●	●	●	●	●	●	●	●
6.70	330	●	●						
7.30	330	●	●						
7.80	330	○	○						
8.30	330	●	●	●	●	●	●	●	●
8.80	330	○	○						
9.30	330	●	●						
9.80	330	○	●						
10.30	330	●	●	●	●	●	●	●	●
10.80	330	●	●						
11.30	330	●	●						
12.30	330	●	●	●	●	●	●	●	●
12.80	330	○	○						
13.30	330	●	●						
14.30	330	●	●	●	○	●	○	●	●
14.80	330	●	●						
15.30	330	●	●						



16.30	330	●	●	●	●	●	●	●	●
16.80	330	●	●						
17.30	330	●	●						
18.30	330	●	●	●	○	●	○	●	●
18.80	330	●							
19.30	330	○	●						
20.30	330	●	●	●	○	●	○	●	●
20.80	330	○	○						
21.30	330	○	●						
22.30	330	●	●						
22.80	330	○							
23.30	330	●	●						
24.30	330	●	●						
25.30	330	●	●	○	○	○	○	●	●
25.80	330	○	●						
26.30	330	●	●						
28.30	330	●	●						
30.30	330	●	●						
32.60	330	●	●						
34.60	330	○	○						
36.60	330	○	○						
38.60	330	○	○						
40.60	330	○	○						
50.60	330	○	○						
60.60	330	○	○						

●标准产品 ○非标产品

长度公差: +5.0

直径公差:

D1.25-5.80: -0.05/+0.15

D6.30-10.30: -0.05/+0.20

D10.80-14.80: -0.05/+0.25

D15.30-20.30: -0.05/+0.30

D20.80-26.30: -0.05/+0.40

D28.30-30.30: -0.05/+0.50

D32.60-60.60: -0.05/+0.60